

SAP 900 aluminium bollard

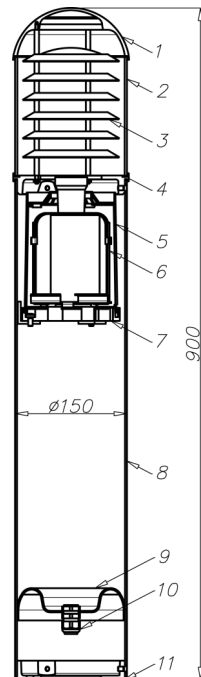

SAP 900



1. Cap
2. PC-UV lamp diffuser
3. Stainless steel louvre reflector
4. Intermediate ring
5. Cover of electrical equipment
6. Gear frame with accessories
7. Insulating separator with ring for mounting gear frame with accessories
8. Pipe $\varnothing 150 \times 2,5$
9. Separator IP 65 for SA
10. Gland PG13,5
11. Base



SAP 900/P

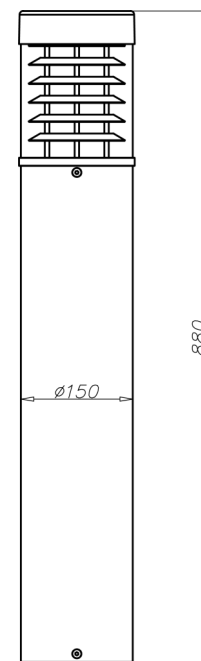

SAP 900 dz

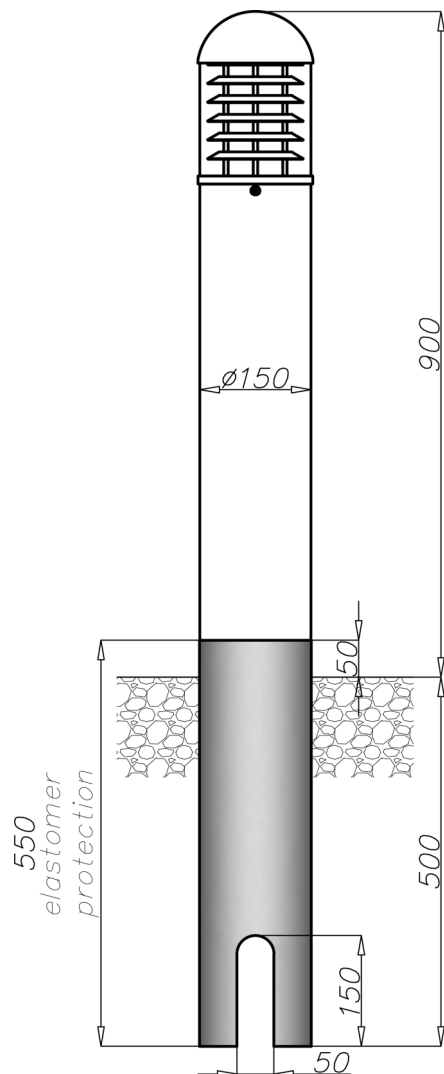

SAP 900/P dz

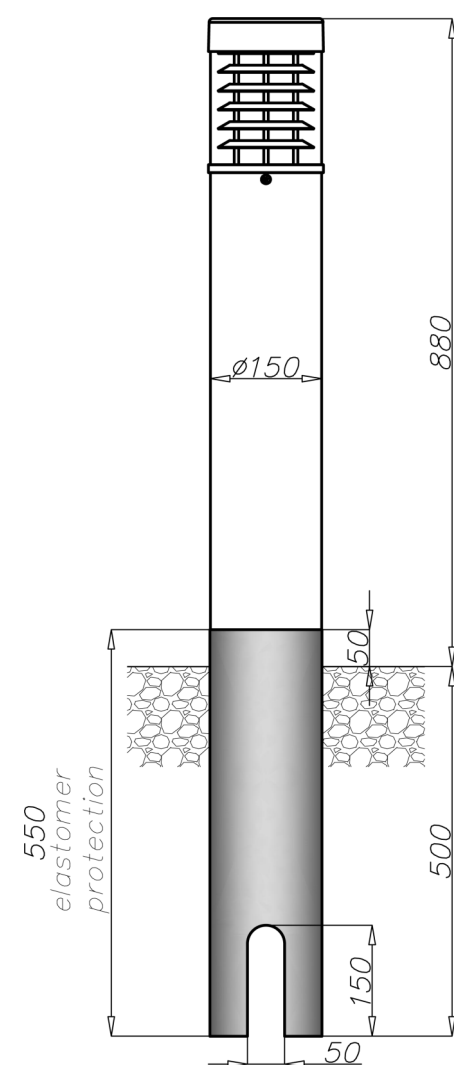

SAP 900 aluminium bollard



Characteristic

Protection degree	IP 65
Voltage	230V, AC
Frequency	50 Hz
Insulation class	II
Material	aluminium alloy tube with external diameter \varnothing 150 mm, cylindrical diffuser PC-UV transparent with stainless steel louvre reflector
Colour	anodized or painted (marked with M) according to RAL pallet
Assembly	on concrete footing B-0, B-0A or reinforcement baskets Z-0, Z-0A using three stretcher pegs \varnothing 8 or directly to the ground (rooted bollards marked dz)
Electrical equipment	mounted on universal gear frame, magnetic ballast with thermal protection for luminaires 50W-100W metal halide lamps MH 70W (EL) optionally available with electronic ballast

Technical data

Light source type	bollard	SAP900	
	type	mounted on footing	dz - rooted
	height [mm]	900	
	unit volume [m ³]	0,023	0,036
sodium S-50W E-27	anodized	45037/C../P	45095/C../P
	painted	45037M, 45037M/P	45095M, 45095M/P
	weight [kg]	5,55	6,75
sodium S-70W E-27	anodized	45038/C../P	45096/C../P
	painted	45038M, 45038M/P	45096M, 45096M/P
	weight [kg]	5,85	6,95
metal halide MH-70W E-27	anodized	45039/C../P	45097/C../P
	painted	45039M, 45039M/P	45097M, 45097M/P
	weight [kg]	5,85	7,05
metal halide MH-70W Electronic E-27	anodized	45039E/C../P	45097E/C../P
	painted	45039ME, 45039ME/P	45097ME, 45097ME/P
	weight [kg]	4,65	5,85
metal halide MH-100W E-27	anodized	45040/C../P	45098/C../P
	painted	45040M, 45040M/P	45098M, 45098M/P
	weight [kg]	6,05	7,15
CSL compact 23w E-27	anodized	45043/C../P	45101/C../P
	painted	45043M, 45043M/P	45101M, 45101M/P
	weight [kg]	4,45	5,65

/P - with flat cap, dz - rooted, M - painted, C.. - anodized

- Low Voltage Directive LVD 2006/95/WE, norm PN-EN 60598-1
- Directive EMC 2004/108/WE, norms: PN-EN 55015, PN-EN 61547, PN-EN 61000-3-2, PN-EN 61000-3-3
- surface: polished aluminium
- anodizing in 12 colours
- option of powder painting in RAL colours (other colours available on request)
- rooted—elastomer protection option in the color of the column to a height of 50 mm (other height on request)
- packing: foil