

# SAM 900 aluminium bollard

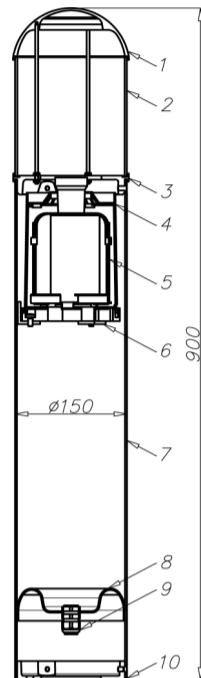

1. Cap
2. PC-UV lamp diffuser
3. Intermediate ring
4. Cover of electrical equipment
5. Gear frame with accessories
6. Insulating separator with ring for mounting gear frame with accessories
7. Pipe  $\varnothing 150 \times 2,5$
8. Separator IP 65 for SA
9. Gland PG13,5
10. Base

SAM 900

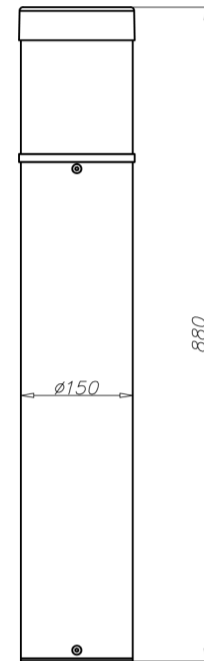

SAM 900/P

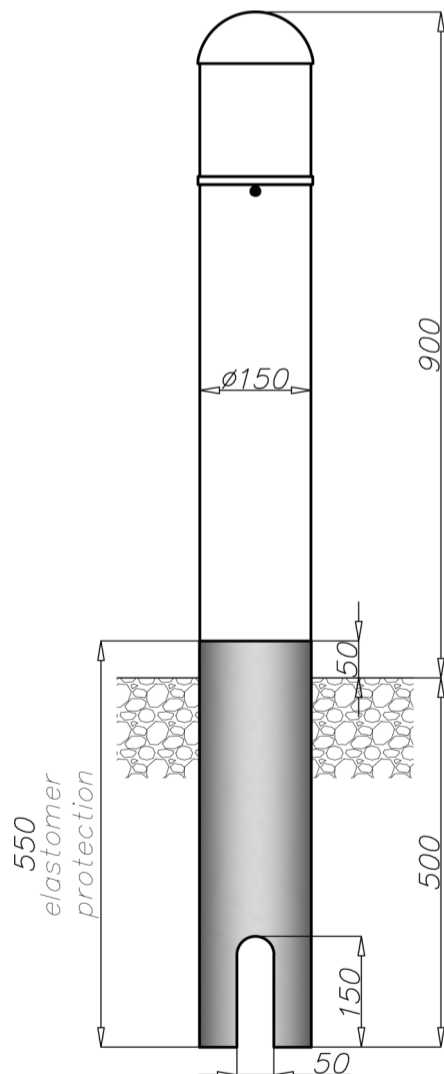

SAM 900 dz

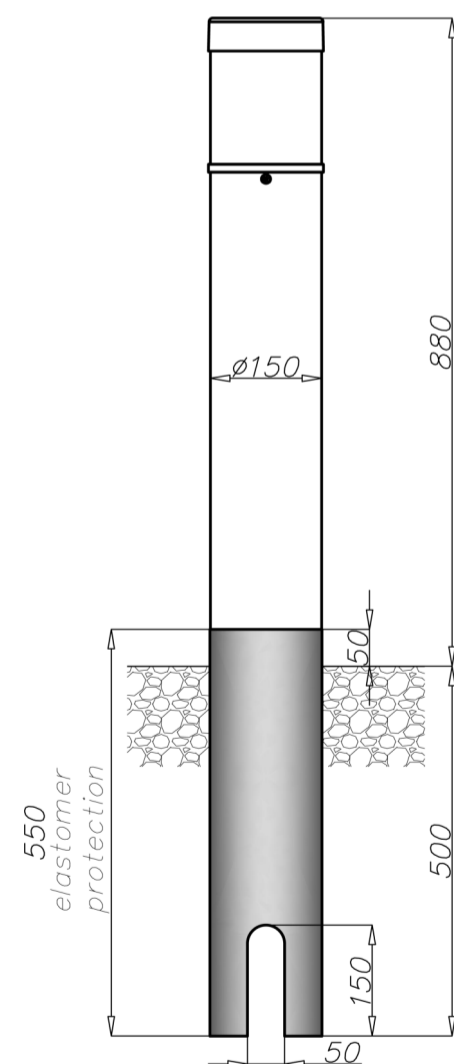

SAM 900/P dz

# SAM 900 aluminium bollard



## Characteristic

Protection degree	IP 65
Voltage	230V, AC
Frequency	50 Hz
Insulation class	II
Material	aluminium alloy tube with external diameter $\varnothing$ 150 mm, cylindrical diffuser white PC-UV
Colour	anodized or painted (marked with M) according to RAL pallet
Assembly	On concrete footing B-0, B-0A or reinforcement baskets Z-0, Z-0A using three strecher pegs $\varnothing$ 8 or directly to the ground (rooted bollards marked dz)
Electrical equipment	mounted on universal gear frame, magnetic ballast with thermal protection for luminaires 50W-100W metal halide lamps MH 70W (EL) optionally available with electronic ballast

## Technical data

Light source type	bollard	SAM 900	
	type	mounted on footing	dz - rooted
	height [mm]	900	
	unit volume [m <sup>3</sup> ]	0,023	0,036
sodium S-50W E-27	anodized	45008/C../P	45067/C../P
	painted	45008M, 45008M/P	45067M, 45067M/P
	weight [kg]	5,35	6,55
sodium S-70W E-27	anodized	45009/C../P	45068/C../P
	painted	45009M, 45009M/P	45068M, 45068M/P
	weight [kg]	5,55	6,75
metal halide MH-70W E-27	anodized	45010/C../P	45069/C../P
	painted	45010M, 45010M/P	45069M, 45069M/P
	weight [kg]	5,65	6,75
metal halide MH-70W Electronic E-27	anodized	45010E/C../P	45069E/C../P
	painted	45010ME, 45010ME/P	45069ME, 45069ME/P
	weight [kg]	4,45	5,55
metal halide MH-100W E-27	anodized	45011/C../P	45070/C../P
	painted	45011M, 45011M/P	45070M, 45070M/P
	weight [kg]	5,75	6,95
CFL compact 23W E-27	anodized	45014/C../P	45073/C../P
	painted	45014M, 45014M/P	45073M, 45073M/P
	weight [kg]	4,45	5,35

/P - with flat cap, dz - rooted, M - painted, C.. - anodized

- Low Voltage Directive LVD 2006/95/WE, norm PN-EN 60598-1
- Directive EMC 2004/108/WE, norms: PN-EN 55015, PN-EN 61547, PN-EN 61000-3-2, PN-EN 61000-3-3

- surface: polished aluminium
- anodizing in 12 colours
- option of powder painting in RAL colours (other colours available on request)
- rooted—elastomer protection option in the color of the column to a height of 50 mm (other height on request)
- packing: foil